

Volute pumps

SKJ

TERAL



Triple e series

50Hz



TERAL INC.

Applications

- Circulation of cold/warm water for high-rise buildings

Features

- ① Energy-saving pump with a Top Runner efficiency (equivalent to IE3) motor.
- ② Robust structure that can be used up to allowable pushing pressure 1.57MPa.
- ③ Low noise because of 4-pole motor drive.
- ④ Adopting totally enclosed fan-cooled indoor motor type.
- ⑤ Improved sealing performance through the adoption of mechanical seal.
- ⑥ With a wide range of water volume secured, stable operation is possible within the specification range.
- ⑦ Simplified and B.P.O. (back pull-out) structure for easy disassembly and maintenance.
- ⑧ Durable for piping load with stable installation because of upright discharge.
- ⑨ Simple and rigid structure based on rational design, allows for reduction in costs, user friendliness, and stable operation.
- ⑩ Compatible mounting dimensions with conventional pumps.

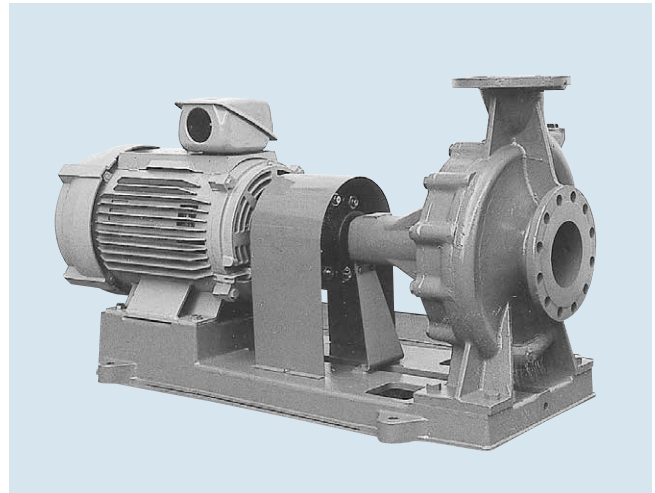

* Please note that some of the devices in the photo may differ from actual devices in coating color, etc.

Description of types

SKJ - 125 × 100 K - 5 5.5 - e

① ② ③ ④ ⑤ ⑥ ⑦

- ① Model
- ② Nominal suction diameter
- ③ Nominal discharge diameter
- ④ Internal code
- ⑤ Frequency 5 : 50Hz
6 : 60Hz
- ⑥ Output
- ⑦ Motor efficiency Top Runner efficiency (equivalent to IE3)

Standard specifications / Special specifications

— : Not available

Pumping liquid	Liquid quality	Fresh water	
	Liquid temperature	0 ~ 80°C	
	Allowable positive pressure	1.57MPa	
	Specifications	Standard specifications	Special specifications
Structure	Impeller	Closed	—
	Shaft seal	Mechanical seal (Sic vs Carbon)	Mechanical seal (Sic vs Sic)
	Bearing	Sealed ball bearing	—
	Gland drain	Drain hole	Cock
	Casing drain	Plug	Cock
	Coupling guard	TERAL standard	Sealed coupling guard
Material	Impeller	CAC406	—
	Shaft	SUS403	SUS304
	Casing	FCD450	—
Motor	Efficiency	Top Runner efficiency (equivalent to IE3)	—
	Starting method	Direct-on-Line start 7.5kW or less Star-delta start 11kW or more	—
	Type	Totally enclosed fan-cooled indoor type	Totally enclosed fan-cooled outdoor type
	Power source	3-phase/200V	3-phase/400V
	Synchronous rotation speed	1500min ⁻¹	—
Piping connection	Suction	JIS16K	—
	Discharge	JIS20K	—
Painting	Paint color	7.5BG5/1.5	Specified color for outer surface
	Painting type	TERAL standard painting	Salt-resistant paint Heavy-duty salt-resistant paint Japan Sewage Works Agency specifications

* Please note that in case of special specifications, the assembl drawing, etc., may differ from the standard drawing.

Standard accessories

Common base	1
Coupling	1 set
Coupling guard	1

* Standard accessories are included in the product components.

Special accessories

Sluice valve, check valve
Pressure gauge, Compound gauge (cock and piping included)
Vibration isolation joint
Vibration isolator
Foot valve
Suction pipe reducer
Anchor bolt

Foot valve / Pipe reducer

Nominal diameter		Foot valve nominal diameter	Pipe reducer
Suction s	Discharge d		
125	100	150	125×150
150	125	200	150×200
200	200	250	200×250
200	150	250	200×250

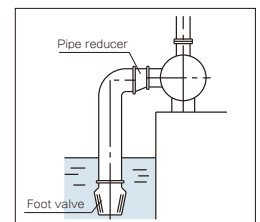

■ Selection chart

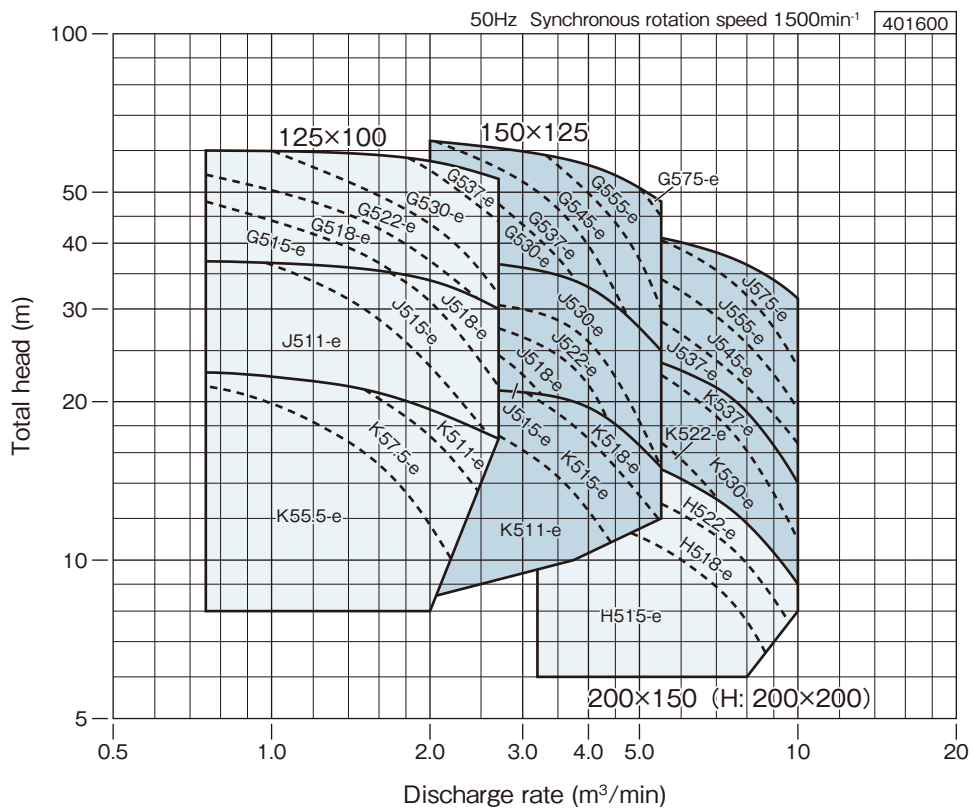

■ Assembly drawing

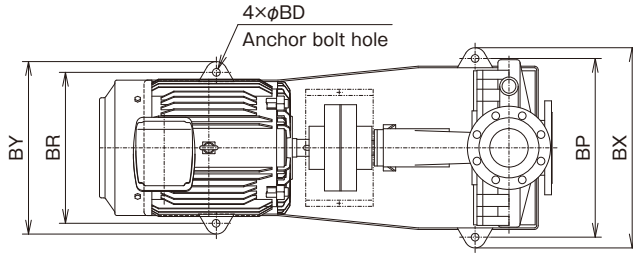

Flange dimensions: Suction side...JIS16K or equivalent
Discharge side...JIS20K or equivalent

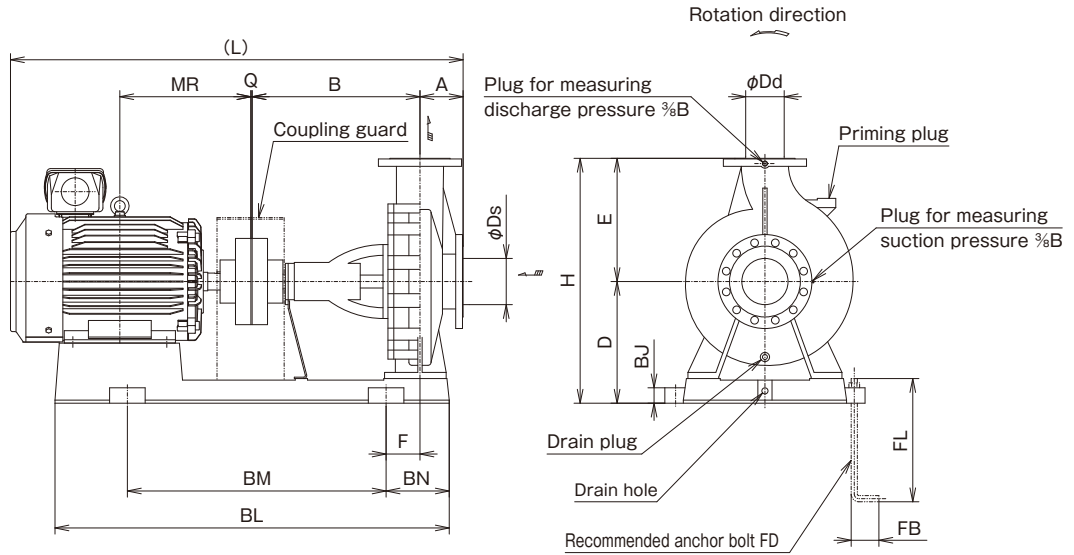

Note) Overall length dimensions, approximate mass and terminal box position may vary depending on the motor manufacturer.

■ Dimensions

(Unit: mm)

Nominal diameter		Type	Output kW	Pump/Motor								
Suction Ds	Discharge Dd			A	B	D	E	F	H	L	Q	MR
125	100	SKJ-125×100K55.5-e	5.5	140	490	320	300	100	620	1084	3	239
		SKJ-125×100K57.5-e	7.5	140	490	320	300	100	620	1122	3	258
		SKJ-125×100K511-e	11	140	490	320	300	120	620	1277	3	323
		SKJ-125×100J511-e	11	140	490	320	335	120	655	1277	3	323
		SKJ-125×100J515-e	15	140	490	320	335	120	655	1307	3	345
		SKJ-125×100J518-e	18.5	140	490	330	335	135	665	1306	3	352
		SKJ-125×100G515-e	15	140	545	360	375	110	735	1362	3	345
		SKJ-125×100G518-e	18.5	140	545	360	375	110	735	1361	3	352
		SKJ-125×100G522-e	22	140	545	360	375	110	735	1361	3	352
150	125	SKJ-150×125K511-e	11	160	490	320	340	120	660	1297	3	323
		SKJ-150×125K515-e	15	160	490	320	340	120	660	1327	3	345
		SKJ-150×125K518-e	18.5	160	490	330	340	135	670	1326	3	352
		SKJ-150×125J515-e	15	140	545	360	355	110	715	1362	3	345
		SKJ-150×125J518-e	18.5	140	545	360	355	110	715	1361	3	352
		SKJ-150×125J522-e	22	140	545	360	355	110	715	1361	3	352
		SKJ-150×125J530-e	30	140	545	360	355	110	715	1400	4	371
		SKJ-150×125G530-e	30	140	545	395	400	110	795	1400	4	371
		SKJ-150×125G537-e	37	140	545	395	400	110	795	1561	4	426
200	200	SKJ-200×200H515-e	15	180	530	360	375	95	735	1387	3	345
		SKJ-200×200H518-e	18.5	180	530	360	375	95	735	1386	3	352
		SKJ-200×200H522-e	22	180	530	360	375	95	735	1386	3	352
200	150	SKJ-200×150K522-e	22	160	530	360	375	95	735	1366	3	352
		SKJ-200×150K530-e	30	160	530	360	375	95	735	1405	4	371
		SKJ-200×150K537-e	37	160	530	360	375	120	735	1566	4	426
		SKJ-200×150J537-e	37	160	670	430	400	120	830	1706	4	426
		SKJ-200×150J545-e	45	160	670	430	400	120	830	1706	4	426
		SKJ-200×150J555-e	55	160	670	430	400	160	830	1715	4	432

Type	Common base									Anchor bolt			Approx. mass kg
	BD	BJ	BL	BM	BN	BP	BR	BX	BY	FB	FD	FL	
SKJ-125×100K55.5-e	20	40	950	660	170	470	340	525	395	70	M16	315	194
SKJ-125×100K57.5-e	20	40	950	660	170	470	340	525	395	70	M16	315	198
SKJ-125×100K511-e	20	40	1080	740	190	470	390	525	445	70	M16	315	251
SKJ-125×100J511-e	20	40	1080	740	190	470	390	525	445	70	M16	315	263
SKJ-125×100J515-e	20	40	1080	740	190	470	390	525	445	70	M16	315	269
SKJ-125×100J518-e	25	50	1120	840	205	480	440	550	510	90	M20	400	333
SKJ-125×100G515-e	25	50	1170	840	205	580	410	650	480	90	M20	400	315
SKJ-125×100G518-e	25	50	1200	840	205	580	440	650	510	90	M20	400	381
SKJ-125×100G522-e	25	50	1200	840	205	580	440	650	510	90	M20	400	392
SKJ-125×100G530-e	25	50	1200	840	205	580	440	650	510	90	M20	400	404
SKJ-125×100G537-e	25	50	1280	940	230	580	490	650	560	90	M20	400	524
SKJ-150×125K511-e	20	40	1080	740	190	470	390	525	445	70	M16	315	258
SKJ-150×125K515-e	20	40	1080	740	190	470	390	525	445	70	M16	315	264
SKJ-150×125K518-e	25	50	1120	840	205	480	440	550	510	90	M20	400	327
SKJ-150×125J515-e	25	50	1170	840	205	580	410	650	480	90	M20	400	303
SKJ-150×125J518-e	25	50	1200	840	205	580	440	650	510	90	M20	400	369
SKJ-150×125J522-e	25	50	1200	840	205	580	440	650	510	90	M20	400	379
SKJ-150×125J530-e	25	50	1200	840	205	580	440	650	510	90	M20	400	391
SKJ-150×125G530-e	25	50	1240	840	205	580	450	650	520	90	M20	400	411
SKJ-150×125G537-e	25	50	1280	840	205	580	490	650	560	90	M20	400	528
SKJ-150×125G545-e	25	50	1280	840	205	580	490	650	560	90	M20	400	544
SKJ-150×125G555-e	25	50	1270	940	230	580	530	650	600	90	M20	400	589
SKJ-200×200H515-e	25	50	1170	840	205	580	410	650	480	90	M20	400	314
SKJ-200×200H518-e	25	50	1200	840	205	580	440	650	510	90	M20	400	380
SKJ-200×200H522-e	25	50	1200	840	205	580	440	650	510	90	M20	400	390
SKJ-200×150K522-e	25	50	1200	840	205	580	440	650	510	90	M20	400	381
SKJ-200×150K530-e	25	50	1200	840	205	580	440	650	510	90	M20	400	392
SKJ-200×150K537-e	25	50	1280	940	230	580	490	650	560	90	M20	400	511
SKJ-200×150J537-e	25	50	1425	940	235	640	490	710	560	90	M20	400	600
SKJ-200×150J545-e	25	50	1425	940	235	640	490	710	560	90	M20	400	616
SKJ-200×150J555-e	25	50	1450	1060	275	640	530	710	600	90	M20	400	669

*Mounting dimensions are compatible with SKJ model (product equipped with totally enclosed fan-cooled IE1 motor). Also the motor frame number is the same. Therefore, replacement with a Top Runner efficiency (equivalent to IE3) motor is possible. However, please keep the following point in mind. The number of revolutions will increase because of the characteristics of the motor, which may cause the flow rate to exceed the rated current value. Please adjust the flow rate to use the motor within the rated current value.

*For products equipped with a drip-proof protected type motor, there are some types which also require a common base because the frame No. may be different when only the motor is replaced.

Example of sectional drawing

●SKJ-125×100K SKJ-150×125K SKJ-200×200H SKJ-200×150K

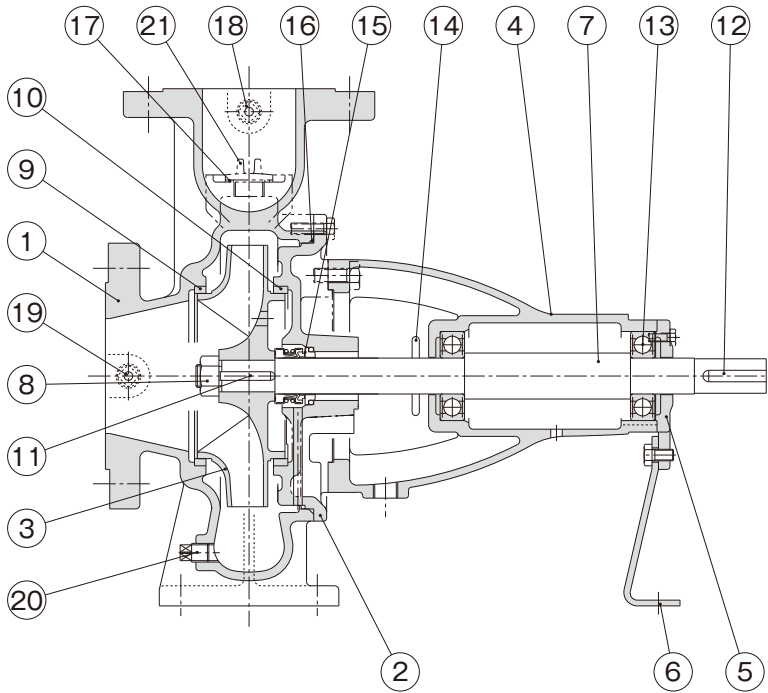

Parts list

No.	Part name	Qty	Material
1	Casing	1	FCD450
2	Casing cover	1	FCD450
3	Impeller	1	CAC406
4	Bearing case	1	FC200
5	Bearing cover	1	FC200
6	Mounting leg	1	SS400
7	Shaft	1	SUS403
8	Impeller nut	1	SUS304
9	Wearing ring	1	CAC406
10	Wearing ring	1	CAC406
11	Impeller key	1	SUS304
12	Coupling key	1	S45C
13	Ball bearing	2	SUJ2
14	Deflector	1	CR
15	Mechanical seal	1	SiC vs Carbon
16	O-ring	1	NBR
17	O-ring	1	NBR
18	Plug	1	SWCH
19	Plug	1	SWCH
20	Drain plug	1	SWCH
21	Priming plug	1	C3771B

Note) The drawing shows standard specifications.
Please contact us for special specifications, because some parts might be different.

●SKJ-125×100J.G SKJ-150×125J.G SKJ-200×150J

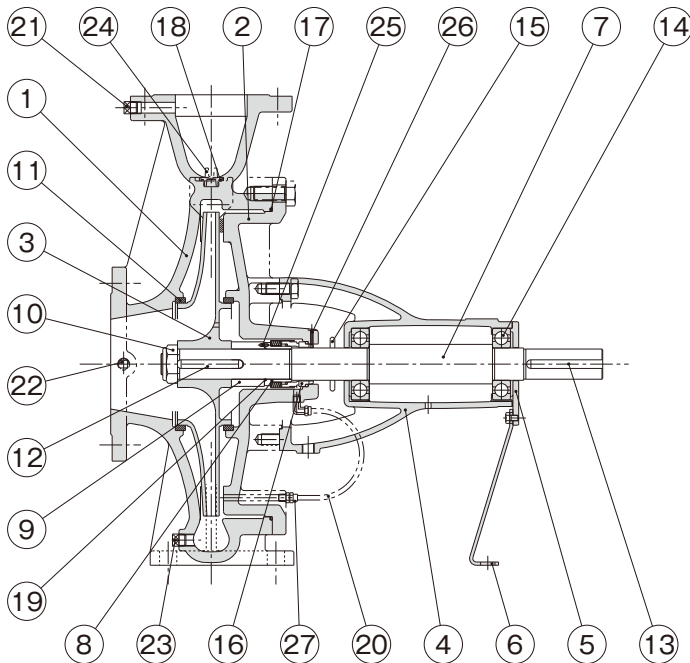

No.	Part name	Qty	Material
1	Casing	1	FCD450
2	Casing cover	1	FCD450
3	Impeller	1	CAC406
4	Bearing case	1	FC200
5	Bearing cap	1	FC200
6	Mounting leg	1	SS400
7	Shaft	1	SUS403
8	Shaft sleeve A	1	SUS403
9	Shaft sleeve B	1	CAC406C
10	Impeller nut	1	SUS304
11	Wearing ring	2	CAC406
12	Impeller key	1	SUS304
13	Coupling key	1	S45C
14	Ball bearing	2	SUJ2
15	Deflector	1	CR
16	Mechanical seal	1	SiC vs Carbon
17	O-ring	1	NBR
18	O-ring	1	NBR
19	O-ring	1	NBR
20	Sealing water pipe	1	NYRON
21	Plug	1	SWCH
22	Plug	1	SWCH
23	Drain plug	1	SWCH
24	Priming plug	1	C3771B
25	Roll pin A	1	SUS304
26	Roll pin B	1	SUS304
27	Conduit coupling	2	C3771B

Note) The drawing shows standard specifications.
Please contact us for special specifications, because some parts might be different.



TERAL INC.

Head Office 230, Moriwake, Miyuki-cyo, Fukuyama-city, Hiroshima, 720-0003, Japan
Tel.+81-84-955-1111 Fax.+81-84-955-5777
www.teral.net

Teral Asia Limited

Room 1001,10/F, Olympia Plaza, 255 King's Road, North Point, Hong Kong
Tel.+852-2571-0935 Fax.+852-2571-0619

TERAL THAI CO.,LTD.

150 Moo 16 Udomsoraryuth Rd., T.Bangkrasan, A.Bangpa-In, Ayutthaya 13160 Thailand
Tel.+66-3535-2148-9 Fax.+66-3535-2150

TERAL TRADING & SERVICE CO.,LTD.

150 Moo 16 Udomsoraryuth Rd., T.Bangkrasan, A.Bangpa-In, Ayutthaya 13160 Thailand
Tel.+66-3535-2145-7 Fax.+66-3535-8549

PT.Teral Indonesia Pumps and Fans

Sinpasa Commercial Blok SB No 001
Jl. Boulevar Selatan Summarecon Bekasi
RT.003/RW.005, Kel. Marga Mulya, Kec. Bekasi Utara, Kota Bekasi, Jawa Barat 17142
TEL:+62-21-8949-4116

Teral Vietnam Limited Liability Company

9th Floor, LADECO Building, No.266 Doi Can Street, Ngoc Ha Ward, Hanoi City, Vietnam
Tel.+84-24-393-52-790 Fax.+84-24-393-52-289

Teral General Machine (Shanghai) Co.,Ltd.

No.285, Yuan Qu Road(N), Bei Qiao, Min Hang District, Shanghai 201109, China
Tel.+86-21-6490-9128 Fax.+86-21-6490-9126

Teral Middle East F.Z.C.

1806-002, 18th floor, BB1, Mazaya Business Avenue, JLT, Dubai, UAE. PO Box 414781
Tel.+971-4369 9039

Teral Pumps & Fans North America Ltd.

Suite # 197, 800-15355 24 Ave Surrey, B.C., CANADA V4A 2H9
Tel.+1-604-839-1008